

Design Guide – Creating Bands and Borders with Pave Stones

Landscape designs are further enhanced when paving bands and borders are incorporated. With a little planning and creativity, geometric patterns, grids and bands can take your pave stone project to the next level in aesthetic appeal. Often the band or border stone will contrast the field stone color. Holland Stone and Plaza Rectangle are often used as border stones. In addition to enhancing design, they also increase structural support for cuts made to field stones.

TIP: Should you have a very narrow area to pave, you could switch your border to a sailor course formation.

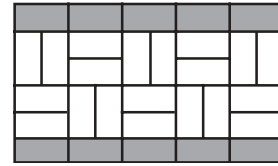

Sailor Course Border

This is an attractive alternative to a soldier course border, and it does present more area for your field stones to establish their pattern.

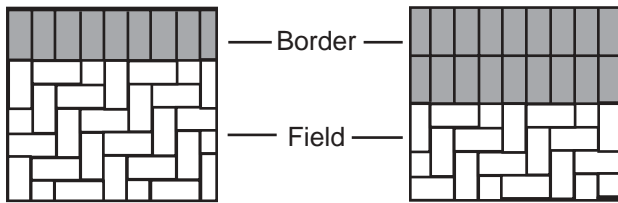

Single Course Border

Double Course Border

Soldier Course Borders



Plaza Stone with single Plaza Stone banding & border.



DecoraStone™ with single Holland Stone banding & border.



City Stone III with Holland Stone banding.

Design Guide – Planning Your Space

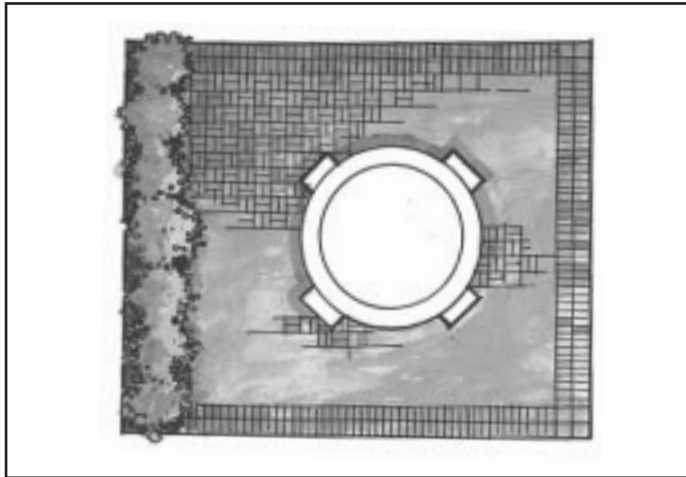

Average patio or breakfast size table
13 ft. diameter or square = 135 to 169 sq. ft.

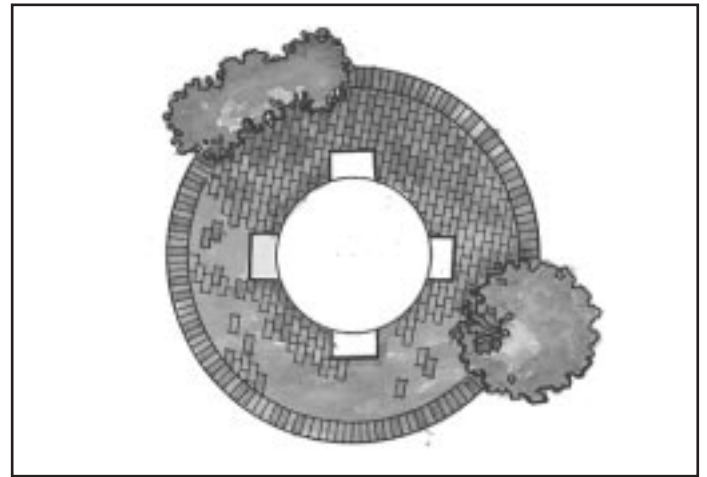

Cafe table with 2 or 3 chairs
10 ft. diameter or square = 90 to 100 sq. ft.

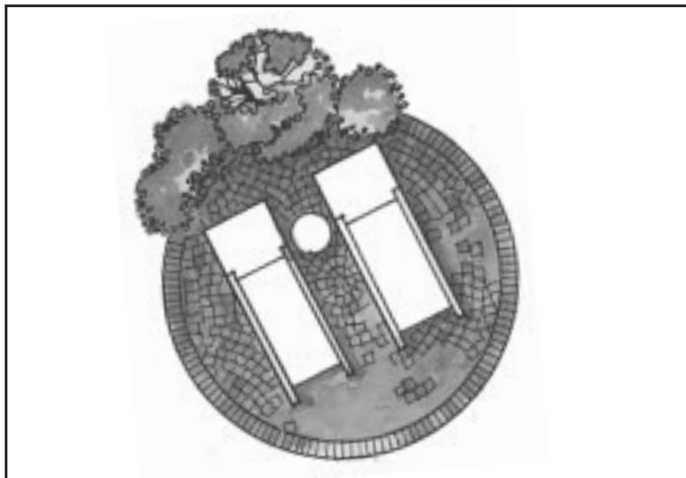

Two lounge or sunning chairs
10 ft. diameter = 90 to 100 sq. ft.

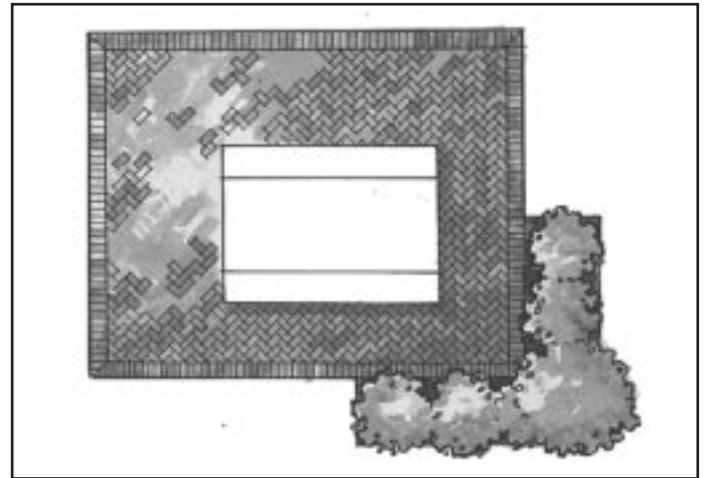

Picnic table
11 x 14 ft. rectangle = 154 sq. ft.

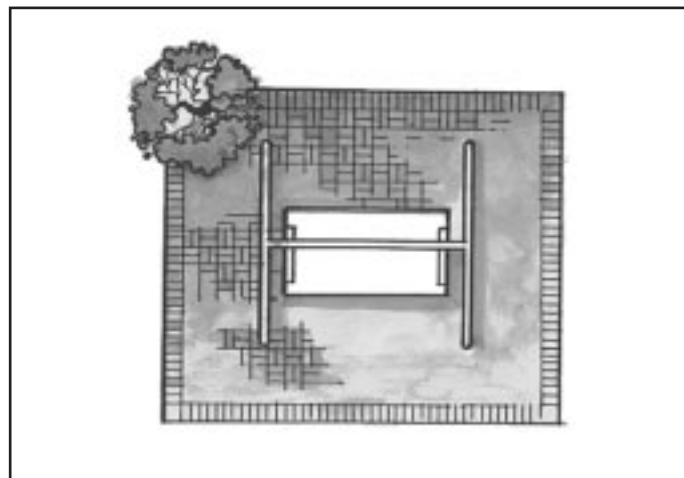

"A" frame porch swing
10 x 12 ft. = 120 sq. ft.

Design Guide – Planning Your Space

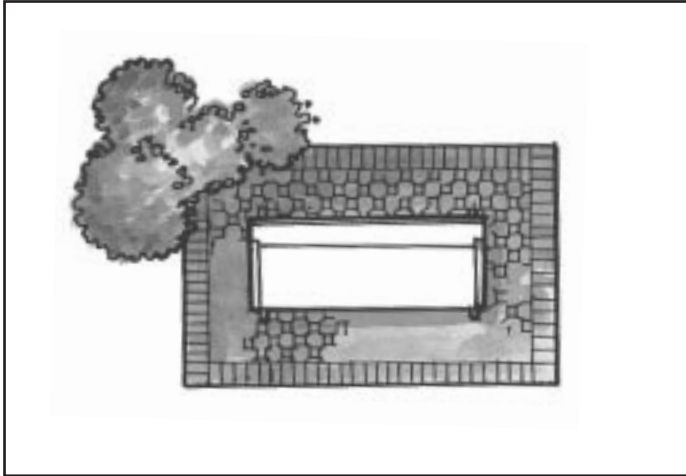

Glider porch swing
8 x 6 ft. = 48 to 50 sq. ft.

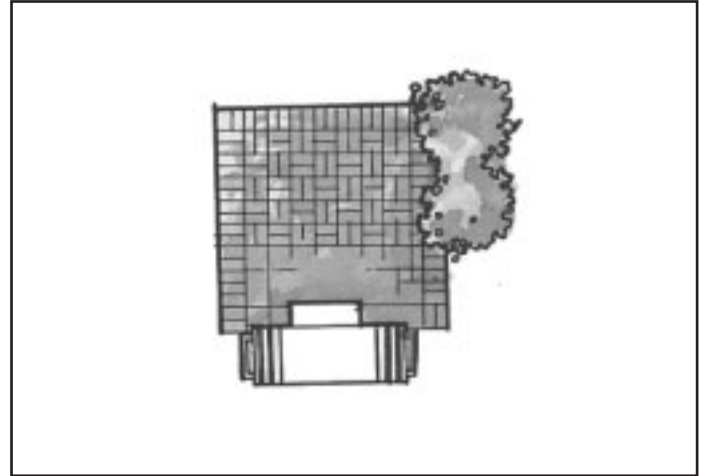

Area to comfortably access a B.B.Q. grill
5 x 5 ft. = 25 sq. ft.

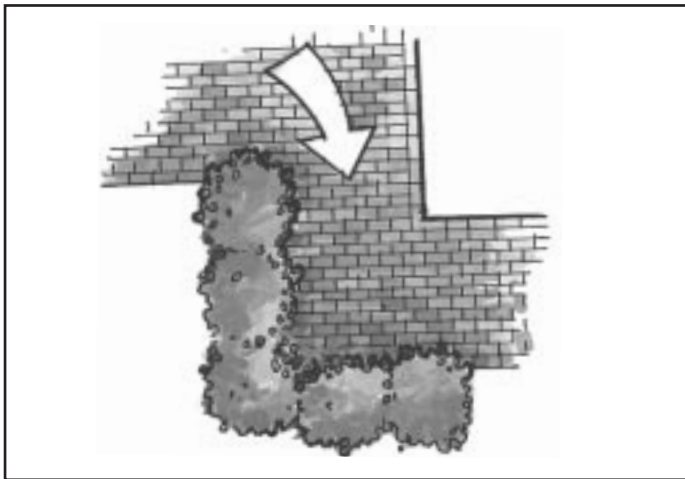

Traffic lane
3 to 4 ft. width x length of pavement area

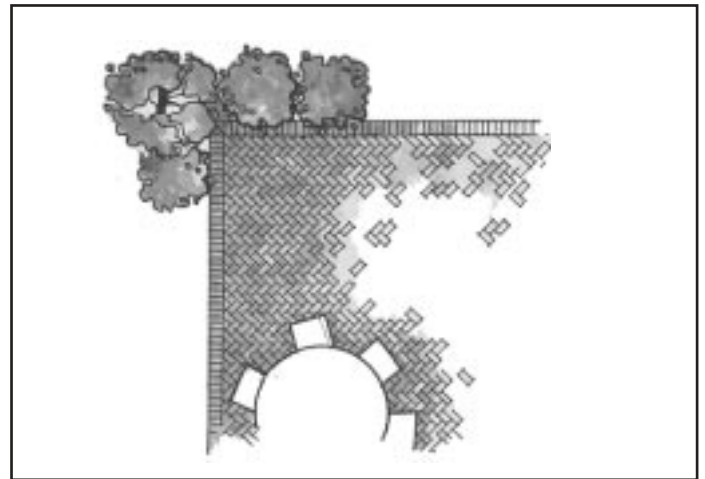

Standing or mixing area
12 x 12 ft. absolute minimum - 144 sq. ft.

All size recommendations are relative to actual patio furniture, traffic flow and design goals. The general rule of thumb is to think first, then design, so that you incorporate all of the necessary components into the design and materials estimation. The requirements shown in this booklet are considered to be absolute minimums.

For example, a 5-ft. table and four (4) chairs may only appear to require a 10-ft. diameter patio.

However, place four (4) adults in those chairs, pulled away slightly from the table as though you are relaxing after a satisfying meal. Now imagine the host/hostess serving dessert. Would he/she be able to walk easily around the table, or would they find themselves walking around with one foot on the patio and one in the flower bed? Anticipating real patio use and traffic flow will enable you to design an appropriate sized setting.

Design Guide – Creating Designs & Patterns with Patio Stones

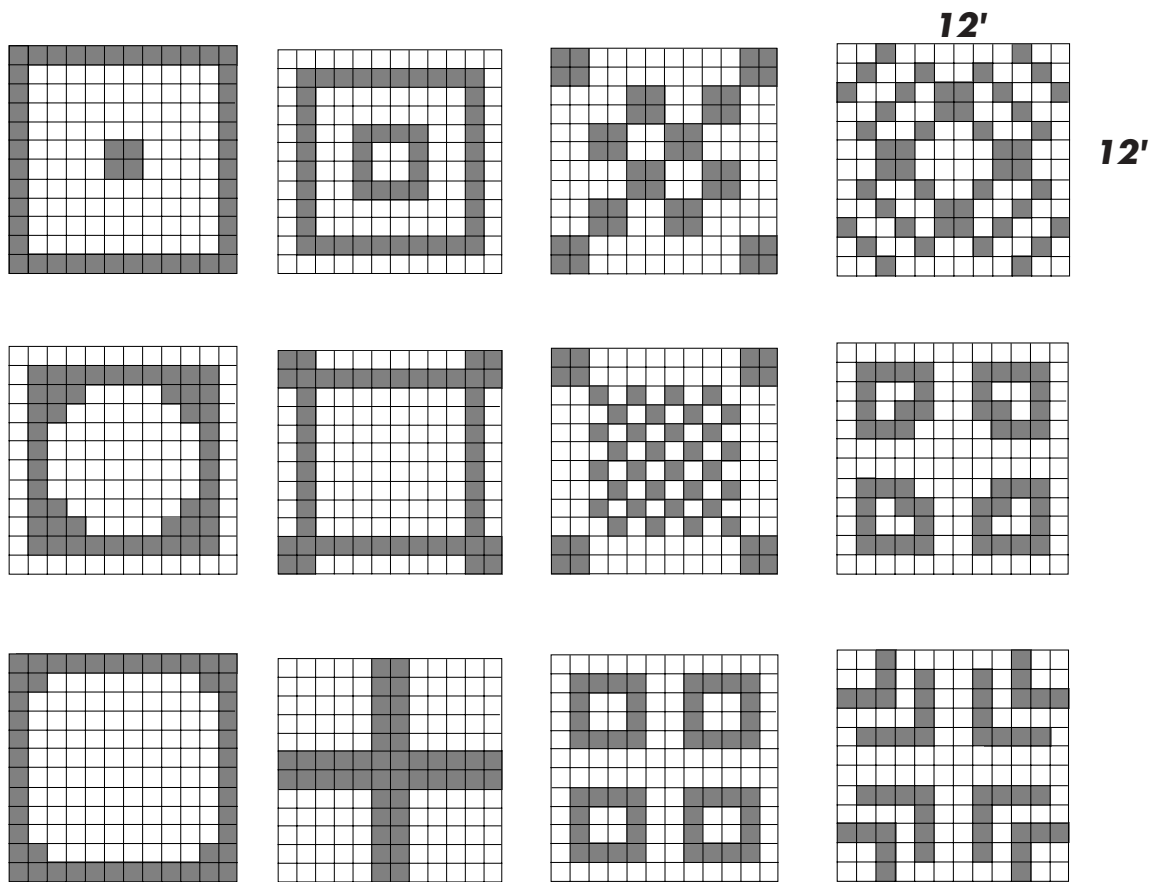

16" stones = 16' x 16' patio

18" stones = 18' x 18' patio

18'

Look what you can create with 96 pieces of 12" square patio stones of your main color and 48 pieces of 12" square patio stones of an accent color. Use one of these designs or use your imagination and create your own!

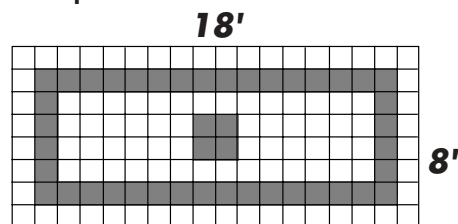
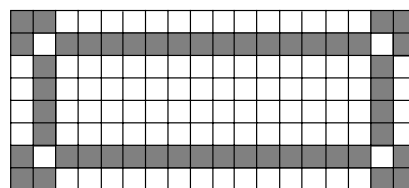

8'

Number of Stones Needed for Other Sizes

Area of Patio or Walk (Sq. Ft.)	12" Stones	2" x 8" x 16" Stones	16" Stones	18" Stones	1" Paver Sand Bed & Sand for Joints (.5 cf. bags)
10	10	12	6	5	2 – Bags
25	25	28	14	12	4 – Bags
75	75	84	42	34	12.5 – Bags
100	100	112	56	45	17 – Bags
150	150	168	84	67	25 – Bags
200	200	224	112	89	33 – Bags

*Aluminum or plastic edge restraint in 6' lengths can be used.